

INTRODUCTION

AP-GXC-0150: 1 PoE IN - to - 1 PoE OUT.

AP-GXC-0250: 1 PoE IN - to - 2 PoE OUT.

The AP-GXC-0150/0250 is outdoor Gigabit PoE extender capable of receiving 90W IEEE 802.3bt PoE power from PSE. Multiple extenders can be cascaded to increase the cabling distance.

PACKAGE CONTENTS

- | | |
|---------------------------|-------------------------------|
| • 1x Outdoor PoE Extender | • 1x Quick Installation Guide |
|---------------------------|-------------------------------|

⚠ IMPORTANT:

1. Install the device in a ventilated and dry place, that is free of electromagnetic source, vibration, moisture, and dust.
2. Make sure the ventilation openings on the extender are not blocked.
3. Use CAT.5e or 6 UTP/STP cables. Avoid using low-quality cables, which will seriously limit the cabling distance.

CONNECTION

Following are the conditions for making the cabling:

1. Use 18~19Ω, 24AWG CAT.5e cables.
2. Typical cameras stream size feature = 1080p@30fps - 6Mbps; 720p@30fps - 3Mbps.

Make sure the combined bandwidth consumption does not exceed the uplink bandwidth from the PoE switch.

NOTE: There are power losses due to cable resistance.

INSTALLATION

AP-GXC-0150

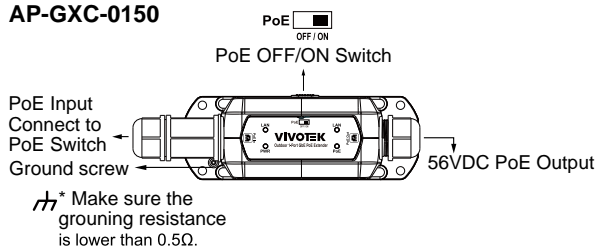

AP-GXC-0250

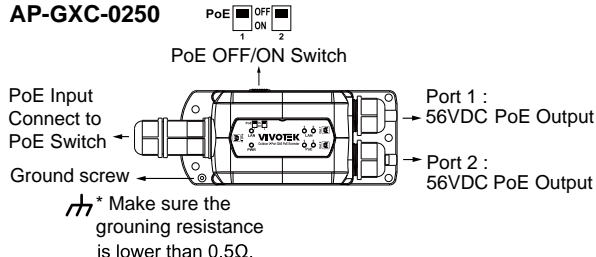

LED DEFINITIONS

PWR	Green ON	PoE IN port is connected to PSE.
	OFF	No PoE IN connection.
PoE	Green or Amber ON	Power over ethernet cable status
	OFF	Ethernet cable no Power
LAN	Green ON	Data link is detected.
	Green Flashing	Data is being transmitted or received.
	OFF	Link is not detected.

DIP SWITCH DEFINITIONS

Pin 1	ON	Port 1 Turn on PoE output
	OFF	Port 1 Turn off PoE output
Pin 2 (AP-GXC-0250 only)	ON	Port 2 Turn on PoE output
	OFF	Port 2 Turn off PoE output

If the device that is going to be connected to this extender is not PoE PD, please turn off the PoE output function.

IMPORTANT:

NOTE:

The Outdoor PoE Extender must be grounded using a ground wire between the ground screw and earth ground.

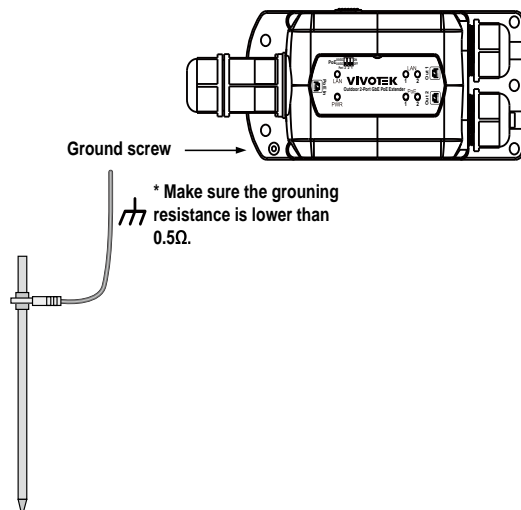

PoE Output Port

To disconnect a LAN cable, loosen the cable gland and pull the cable against the socket wall towards the side of the locking tab.

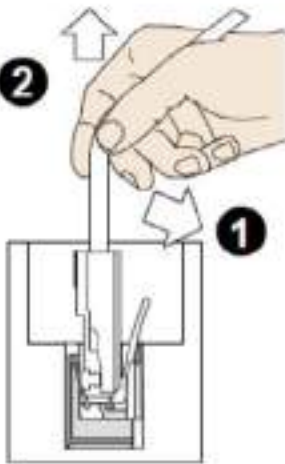

PoE Input Port Connector Assembly

IMPORTANT -

please follow the procedures below carefully to ensure the best seal:

1. Fit a RJ45 plug to the Cat5e/6 cable
2. Thread the Cat5e/6 cable through the cap(A) & grip(B)
3. Split rubber(C), rubber have two sizes for meet 4.5~6.5mm Cat5e/6 cable.
4. Fit the split rubber(C) over the Cat5e/6 cable
5. Thread the Cat5e/6 cable through the body(D)
6. Fit the washer(E) to the Outdoor PoE Extender connector
7. Plug the RJ45 connector on the Cat5e/6 cable into the Outdoor PoE Extender
8. Hold Outdoor PoE Extender and then screw the body(D) onto the Outdoor PoE Extender connector tighten firmly
9. Push rubber(C) in the grip(B) and screw the cap tighten firmly. The Cat5e/6 cable is sealed when the rubber(C) & grip(B) bulges to the edge of the cap(A).

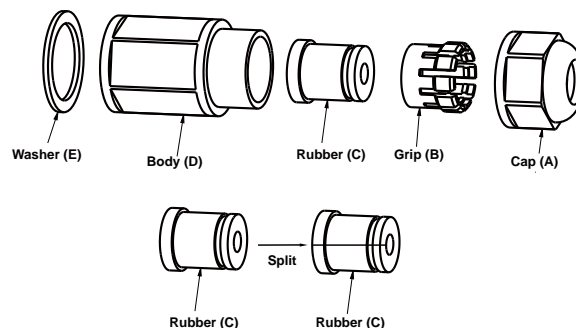

Application

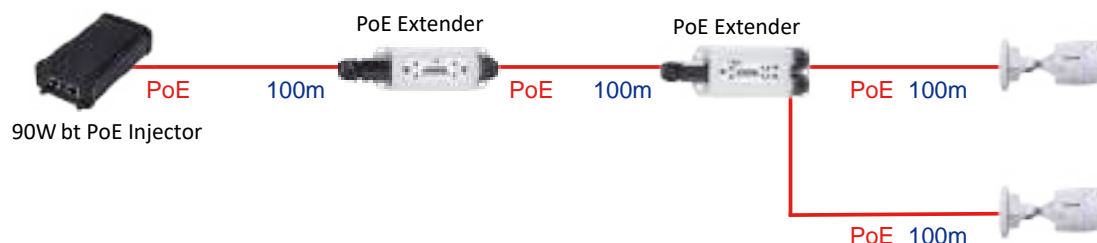

All specifications are subject to change without notice.
Copyright © 2022 VIVOTEK INC. All rights reserved.

VIVOTEK INC.

6F, No.192, Lien-Cheng Rd., Chung-Ho, New Taipei City, 235, Taiwan, R.O.C.
T: +886-2-82455282 F: +886-2-82455532 E: sales@vivotek.com

VIVOTEK USA, INC.

2050 Ringwood Avenue, San Jose, CA 95131
T: 408-773-8686 F: 408-773-8298 E: salesusa@vivotek.com

VIVOTEK Europe

Zandsteen 15, 2132 MZ Hoofddorp Delta Electronics
T: +31 (0)20 800 3817 E: sales@vivotek.com