

1 Product Overview

PoE Extender is mainly used to cooperate with High PoE Midspan to form long-distance transmission plan, transmit Ethernet data via Cat5/5e/6 network cable and supply power for IP Camera, cascade multilevel transmission 300m.

1.1 Features

- Support passive PoE cascade power supply and Ethernet data exchange.
- Support IEEE 802.3af/at standard power supply IP Camera.
- 1* RJ45 10/100M PoE power supply input; 1* RJ45 10/100M supply power for IP Cam; 1* RJ45 10/100M supply power for the next extender.
- Cooperate with High PoE Midspan (DH-PFT1200), able to cascade level 2 PoE Extender, connect to 3 IPC (power consumption <=BW), max transmission distance 300m.
- Interface: 1* RJ45 10/100M port in, 1* RJ45 10/100M port PoE power out.
- Indicator: Internet access Link/Act indication.
- Working temperature: -30°C ~ 65°C.
- Installation mode: junction box internal mounting, DIN rail mounting.

1.2 Typical Application

See Figure 1-1 for more details about typical networking scene.

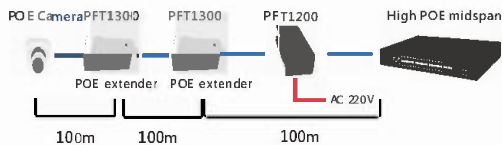

Figure 1-1

2 Device Structure

2.1 Appearance Port

Front panel

The front panel is shown in Figure 2-1.

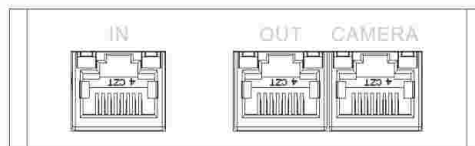

Figure 2-1

Important Safeguard and Warning

Please read the following safeguards and warnings carefully before using the product in order to avoid damages and losses.

Note:

- Do not expose the device to lampblack, steam or dust. Otherwise it may cause fire or electric shock.
- Do not install the device at position exposed to sunlight or in high temperature. Temperature rise in device may cause fire.
- Do not expose the device to humid environment. Otherwise it may cause fire.
- The device must be installed on solid and flat surface in order to guarantee safety under load and earthquake. Otherwise, it may cause device to fall off or turnover.
- Do not place the device on carpet or quilt.
- Do not block air vent of the device or ventilation around the device. Otherwise, temperature in device will rise and may cause fire.
- Do not place any object on the device.
- Do not disassemble the device without professional instruction.

Warning:

- Please use battery properly to avoid fire, explosion and other dangers.
- Please replace used battery with battery of the same type.
- Do not use power line other than the one specified. Please use it properly. Otherwise, it may cause fire or electric shock.

Special Announcement

- This manual is for reference only.
- All the designs and software here are subject to change without prior written notice.
- All trademarks and registered trademarks are the properties of their respective owners.
- If there is any uncertainty or controversy, please refer to the final explanation of us.
- Please visit our website for more information.

Refer to Sheet 2-1 for more details.

Interface Name	Note
IN	1*10/100M RJ45 port, receive PoE power supply port; yellow indicator shows Internet access Link status, green indicator shows network access Act status.
OUT	1*10/100M RJ45 port, PoE power supply port, used to supply power for the next PoE Extender; yellow indicator shows Internet access Link status, green indicator shows network access Act status.
CAMERA	1*10/100M RJ45 port, PoE power supply port, used to supply power for IP Camera; yellow indicator shows Internet access Link status, green indicator shows network access Act status.

Sheet 2-1

3 Installation Guide

3.1 Install Device

PoE Extender supports two installation modes which are junction box internal mounting and DIN rail mounting.

1 The junction box internal mounting is shown in Figure 3-1.

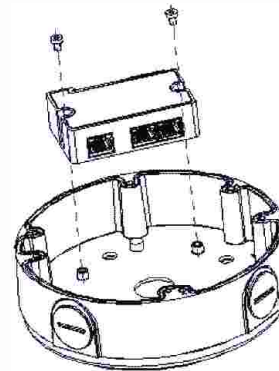

Figure 3-1

2 The DIN rail mounting is shown in Figure 3-2.

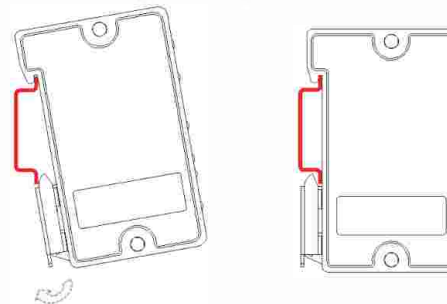
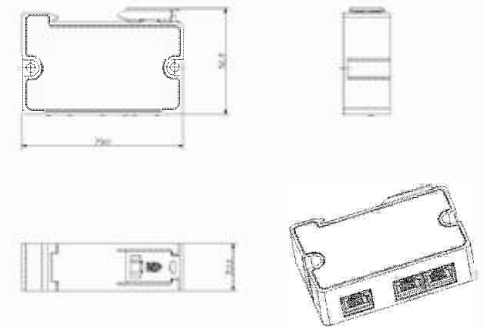

Figure 3-2

4 Appendix 1 Technical Specification

Technical Parameter	DH-PFT1300
Business Interface	1*10/100 Base-T POE power receiving port 1*10/100 Base-T POE power supply port, supply power for the next extender 1*10/100 Base-T POE power supply port, supply power for IPC
PoEIn	Pin assignment and polarity: Both 1/2 (-), 3/6 (+) and 7/8 (-), 4/5 (+)
POEOut	CAMERA port supports IEEE 802.3af, OUT supports 802.3af/at, pin assignment and polarity: Both 1/2(-), 3/6(+) and 7/8(-), 4/5(+)
Transmission Distance	Cooperate with DH-PFT1200, able to cascade level two extender, connect to 3 IPC (level one extender connects to 1 IPC, the OUT port of level two extender and CAMERA port connect to 1 IPC respectively, IPC power consumption <=8W), transmission distance is 300m
Lightning Protection Level	Level 4
Power Consumption	<=3W
Operating Humidity	10% ~ 90%
High & Low Temperature	-30°C ~ 65°C
Weight	57g
Dimension	79mm*52mm*23mm

The device dimension is shown in the following figure.



Note:

- This user's manual is for reference only.
- Slight difference may be found in user interface.
- All the designs and software here are subject to change without prior written notice.
- All trademarks and registered trademarks are the properties of their respective owners.
- If there is any uncertainty or controversy, please refer to the final explanation of us.
- Please visit our website for more information.