

VRLA Battery

CBAT24AH

12V24AH

MS Series SLA Battery

Baterías de tamaño pequeño

- 100% before shipment testing, stable and reliable long-term quality
- patented grid alloy formula and updated manufacturing technique
- completely sealed and maintenance-free, low self-discharge
- Excellent charging and re-charging acceptance
- Cycle use: More than 260 cycles at 100% DOD
- Floating & standby use: 3-5 years

Application:

- Alarm System
- Cable Television
- Communication Equipment
- Emergency Power System
- Security System
- Medical Equipment
- UPS
- Power tools
- Control Equipment
- Toys

Construction:

- ComponentRaw material
- PositiveLead dioxide
- NegativeLead
- ContainerABS
- CoverABS
- SealantEpoxy
- Safety valve Rubber
- TerminalCopper
- SeparatorFiber glass
- ElectrolyteSulfuric acid

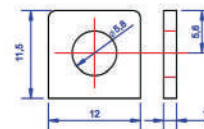

M5 Bolt & Nut

T1 Terminal

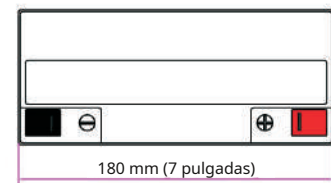
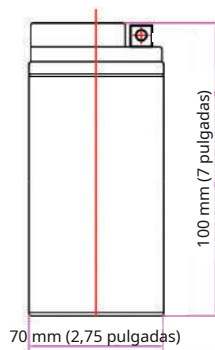
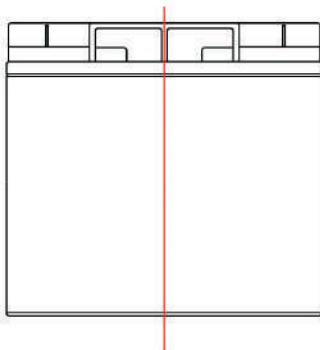

Speification:

Battery Model	12V24AH			
Designed Floating Life	3~5 Years			
Capacity (25°C)	1.2A	2.14A	3.84A	14.4A
	24H	21AH	18.7AH	14.4AH
Dimensions	Length	Width	Height	Total Height
	181mm (7.12inch)	77mm (3.03inch)	160mm (6.30inch)	167mm (6.57inch)
Approx. Weight	7,9 kg (17,4 libras)			
Internal Resistance	Full charged at 25°C: ≤12.0mΩ			
Self Discharge	3% of capacity declined per month at (25°C)			
Capacity Affected by Temp.(20HR)	40°C	25°C	0°C	-15°C
	102%	100%	85%	65%
Charge Voltage(25oC)	Cycle use		Float use	
	14.4-15.0V(-30mV/°C), max. Current: 7.2A		13.5-13.8V (-20mV/°C)	

Voltaje terminal (V) y tiempo de descarga

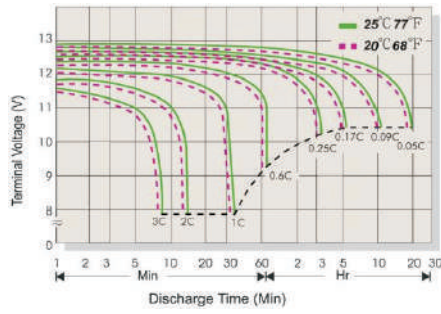

Característica de retención de capacidad

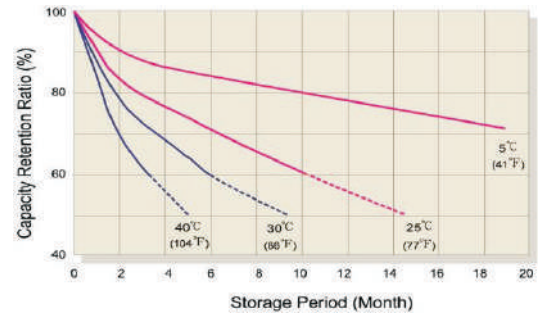

Voltaje de batería y tiempo de carga para uso en espera

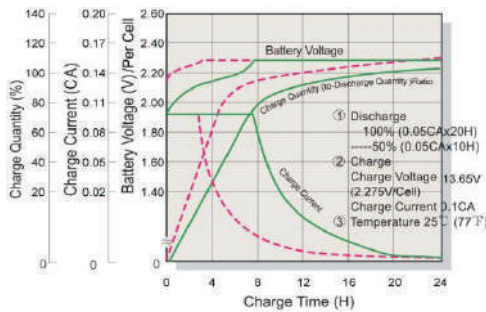

Voltaje de la batería y tiempo de carga para el uso del ciclo

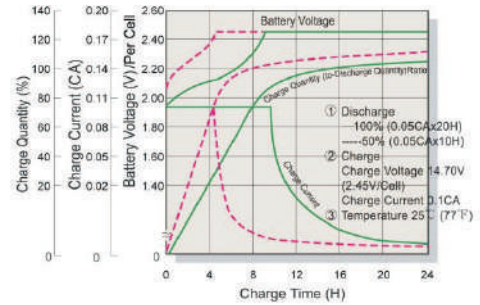

Cosquillas (o Flotar) Servicio Vida

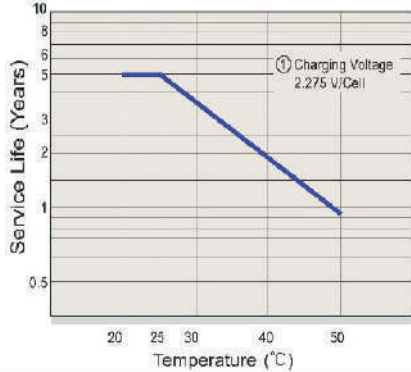

CycleServiceLife

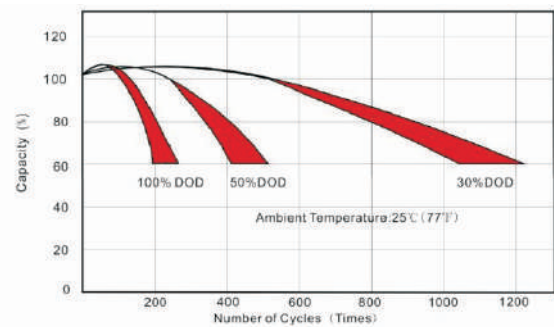

Descarga de corriente constante(CC,Unidad:A) a las 25°C(77°F)

VF/Tiempo	5 minutos	10 minutos	15 minutos	20 minutos	30 minutos	1 hora	2 horas	3 horas	5 horas	10 horas
1.80VPC	86.62	58.04	48,01	39,66	24,63	15.83	9.14	6.15	4.27	2.42
1.75VPC	87.15	58.57	50,56	40,54	25,06	16.18	9.36	6.33	4.47	2.55
1.70VPC	87.41	58.83	50,83	40,80	25,48	16.44	9.62	6.51	4.60	2.62
1.65VPC	87.58	59.00	51,01	40,98	25,86	16.80	9.94	6.73	4.75	2.64
1.60VPC	87.77	59.19	51,18	41,15	26,41	17,17	10.16	6.83	4.84	2.72

Descarga de potencia constante(PC,Unidad:W) a las 25°C(77°F)

VF/Tiempo	5 minutos	10 minutos	15 minutos	20 minutos	30 minutos	1 hora	2 horas	3 horas	5 horas	10 horas
1.80VPC	909,51	609,42	526,32	416,44	258,54	166,20	96.03	64.64	44,78	25,39
1.75VPC	915,05	614,96	530,93	425,67	263,16	169,90	98.24	66.48	46,96	26,78
1.70VPC	917,82	617,73	533,70	428,44	267,77	172,67	100,83	68,33	48,25	27,51
1.65VPC	919,67	619,58	535,55	430,29	272,39	176,36	104,34	70,64	49,86	27,70
1.60VPC	921,51	621,42	537,40	432,13	277,29	180,06	106,19	71,56	50,78	28,62