

DH-HAC-HDBW1200RA-Z

2MP IR HDCVI Motorized Vari-Focal Vandal-proof Dome Camera



* The parameters and datasheets below can only be applied to 1200-S6 series.

- Max. 30 fps@1080p.
- Smart IR Illumination.
- 60 m illumination distance.
- Super Adapt.
- 2.7 mm–12 mm motorized lens.
- CVI/CVBS/AHD/TVI switchable
- IP67, IK10, 12 VDC



Series Overview

The Lite Series is a great choice for consumers looking for high quality monitoring products at a reasonable price. Its low cost and high performance make it ideal for residential areas and SMB solutions. This series is equipped with a wide range of technologies, such as full-color and starlight, providing various solutions for different scenarios.

Functions

Smart IR Illumination

With its IR illumination, the camera provides optimal performance in low light conditions, ensuring uniformity in the brightness of B/W images. Through its smart IR technology, the camera also compensates for the distance of targets by adjusting the intensity of its IR LEDs, preventing overexposure of images as targets move closer to the camera.

Super Adapt

With its intelligent algorithm, the camera automatically adjusts its parameters to provide optimal performance and vivid images.

Advanced 3DNR

Dahua's advanced 3DNR technology reduces image noise with little to no impact on image sharpness, especially in poor lighting conditions. It detects the noise, and compares the sequential frames to effectively reduce the noise. It also makes efficient use of bandwidth, saving on storage space.

Protection (IP67, IK10, Wide Voltage)

IP67: The camera passed a series of rigorous dust and immersion tests. Its enclosure is both dust-proof and waterproof, and can function normally while being immersed in 1 m deep water for up to 30 minutes.
IK10: The enclosure can withstand up to 5 punches from a 5 kg hammer falling from a height of 40 cm (impact energy is 20 J).
Wide voltage: The camera has $\pm 30\%$ input voltage tolerance (for some power supplies) and a wide voltage range, making it suitable for a variety of outdoor scenarios.

4 Signals over 1 Coaxial Cable

HDCVI technology supports 4 signals (video, audio*, data and power) which are simultaneously transmitted over a coaxial cable. Dual-way data transmission allows the HDCVI camera to interact with the XVR to perform various actions such as sending control signals and triggering alarms. HDCVI technology also supports PoC, which makes the camera easy and quick to install.

* Audio input is available for select HDCVI camera models.

Long Distance Transmission

HDCVI technology provides long distance transmission in real time without transmission loss. It supports transmission distances up to 700 m for 2-MP/5-MP/8-MP HD videos through coaxial cables, and up to 300 m through UTP cables. The results were obtained and verified through rigorous testing in Dahua's test laboratory.

Technical Specification							
Camera						Gain Control	Auto
Image Sensor						Noise Reduction	3D NR
Max. Resolution						Illumination Mode	Smart IR
Scanning System						Mirror	Yes
Electronic Shutter Speed						Privacy Masking	Off/On (8 areas, rectangle)
Min. Illumination						Certification	
S/N Ratio						Certifications	CE-LVD: EN 62368-1; CE-EMC: EN 55032; EN 55035; FCC: 47 CFR FCC Part 15, Subpart B; UL: UL62368-1 + CAN/CSA C22.2 No. 62368-1-14
Illumination Distance						Port	
Illuminator On/Off Control						Video Output	Video output choices of CVI/TVI/AHD/CVBS by one BNC port
Illuminator Number						Power	
Angle Adjustment						Power Supply	12 VDC ± 30%
						Power Consumption	Max 4.1 W (12 VDC, IR on)
Lens						Environment	
Lens Type						Operating Temperature	−30 °C to +60 °C (−22 °F to +140 °F)
Auto Focus						Operating Humidity	<95% (RH), non-condensing
Lens Mount						Storage Temperature	−30 °C to +60 °C (−22 °F to +140 °F)
Focal Length						Storage Humidity	<95% (RH), non-condensing
Max. Aperture						Protection	IK10; IP67
Field of View						Anti-corrosion Level	Basic Protection
Iris Control						Structure	
Close Focus Distance						Casing Material	Metal
DORI Distance	Lens	Detect	Observe	Recognize	Identify	Product Dimensions	φ126 mm × 100 mm (φ4.96" × 3.94")
	2.7 mm	47.4 m (155.51 ft)	18.9 m (62.01 ft)	9.5 m (31.17 ft)	4.7 m (15.42 ft)	Net Weight	0.63 kg (1.38 lb)
	12 mm	155.6 m (510.50 ft)	62.2 m (204.07 ft)	31.1 m (102.03 ft)	15.6 m (51.18 ft)	Gross Weight	0.81 kg (1.78 lb)
Video						Installation	Wall mount; ceiling mount; vertical pole mount
Video Frame Rate							
Resolution							
Day/Night							
BLC							
WDR							
White Balance							

Ordering Information		
Type	Model	Description
2MP Camera	DH-HAC-HDBW1200RAP-Z	2MP IR HDCVI Motorized Vari-Focal Vandal-proof Dome Camera, PAL
	DH-HAC-HDBW1200RAN-Z	2MP IR HDCVI Motorized Vari-Focal Vandal-proof Dome Camera, NTSC
Accessories (Optional)	PFA197R	Junction Box
	PFB206W	Wall Mount Bracket
	PFA109	Mount Adapter
	PFB220C	Ceiling Mount Bracket
	PFA156	Pole Mount Bracket
	PFM800-E	Passive HDCVI Balun
	PFM321	12V 1A Power Adapter
	PFM904	Integrated Mount Tester

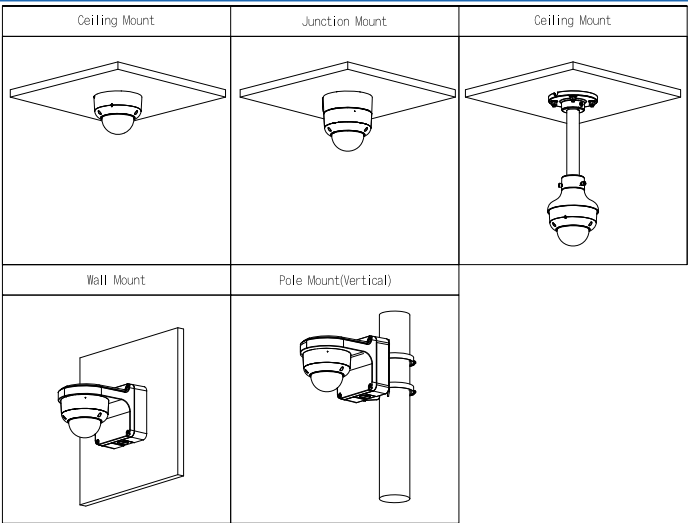

Dimensions (mm[inch])

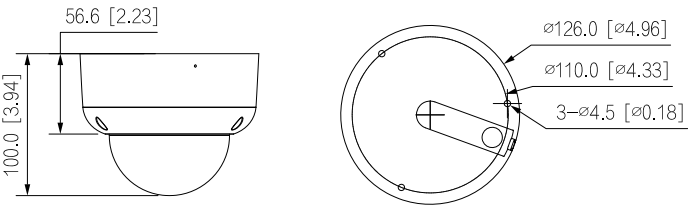

Accessories

Optional:



PFA197R
Junction Box



PFB206W
Wall Mount Bracket



PFA109
Mount Adapter



PFB220C
Ceiling Mount Bracket



PFA156
Pole Mount Bracket



PFM800-E
Passive HDCVI Balun



PFM321
12V 1A Power Adapter



PFM904
Integrated Mount Tester